

eSIGNO MOBILE

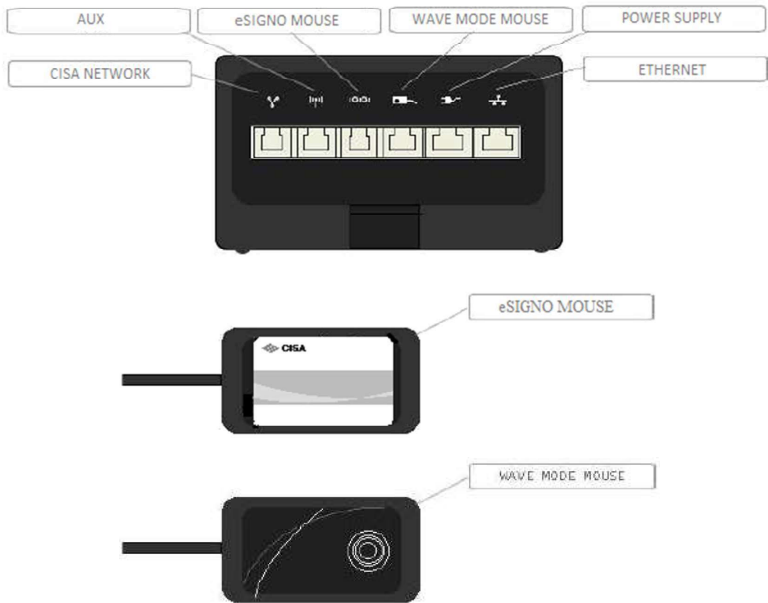



* Double function button : the function varies according to the device working mode



eSIGNO MOBILE DEVICE

The eSIGNO mobile can be used in two different modes:

 <p>Encoder mode: to read, issue and search for cards and to communicate with your own pc through the provided software.</p>	 <p>HMI mode: to configure and synchronize the locks and to read the lock audit trails.</p>
------------------------------------------------------------------------------------------------------------------------------------------------------------------------------------------------------------------------	-----------------------------------------------------------------------------------------------------------------------------------------------------------------------------------------



ENCODER/HHI LOGIN

Before doing any operation log on to the eSIGNO encoder with the operator card.



TIP

To change the operator password:

- log on to the encoder;
- read the operator card;
- press ;
- switch to Display/Modify Password with ;
- type the new password, overwriting the old one.



eSIGNO MOBILE DEVICE



ENCODER MODE OR HHI MODE ?

When switching on the eSIGNO Mobile, before doing any operation, check if the device is in Encoder stand-by mode or in HHI stand-by mode.

ENCODER STAND-BY MODE

```
WWWAVE MODE DEMO
SERVER #000dH00
21/01/07 15:30
<READ OPER.CARD<
```

HHI STAND BY MODE

```
WWWAVE MODE DEMO
SERVER #000dH00
21/01/07 15:30
<READ HHI OP.C.<
```

To switch from HHI mode to Encoder mode, simply press and follow the steps below:

```
HHI #000
09/03/09 13:50
QUIT AND
< LOGOUT HHI <
```

```
CISA HOTEL
SERVER #000dH00
26/01/09 17:20
<READ OPER.CARD<
```

- navigate with to the Logout HHI option;
- press ;
- select Yes. The eSIGNO Mobile device switches to Encoder mode;
- move the operator card above the tag reader of the device;
- type your password and press : you are now logged in Encoder mode.

To switch from Encoder mode to HHI mode, simply press and follow the steps below:

```
* WARNING! *
RISKY OPERATION!
HHI MODE LOGIN?
< YES <
```

```
CISA HOTEL
SERVER #000dH00
09/03/09 14:23
<READ HHI OP.C.<
```

- press once again;
- press to answer Yes to the Are You Sure? question, then press ;
- press to answer Yes to the HHI Mode Login? question, then press ;
- move the operator card above the tag reader of the device;
- type your password and press : you are now logged in HHI mode.

KEYBOARD

The ESIGNO Mobile provides an enhanced keyboard, featuring a group of multifunctional keys whose function depends upon the cursor position and the working mode (Encoder or HHI).





ALPHANUMERIC KEYS

The buttons from 1 to 9 can be used to input either letters or digits in text or numeric fields:

- the first time you press one of these buttons a digit is displayed;
- with the following pressings of the same key, the letters printed on the button are then displayed;
- at the end of each sequence, another pressing of the button makes the sequence start again.

If you need to compose a word made of more than 1 character:

- select the first character by pressing the proper button;
- if the second character is listed in the same button, press  or wait 1 second for the cursor to automatically move into next position; instead, if the second character is contained in another key, simply press it to insert the character into next position;
- to erase the last character displayed, press ;
- to leave a blank space or to move to the next position press .

DOUBLE FUNCTION KEYS

The function of these buttons depends upon the eSIGNO Mobile working mode, i.e. Encoder (white background) or HHI (grey background).



Enhanced display: to display all the card details.

Info: to retrieve information from the locks.



Check-out: to check-out the displayed guest card (this will only make the card inactive, but it will not cancel it from the database).

Synchro: used to synchronize the locks with the HHI.



Menu: to access to the encoder menu.

Audit trail readout: to read the operations performed on a lock.



Copy guest card: to quickly copy a guest card.

Print: to print information stored in memory, using a PC.



eSIGNO
MOBILE DEVICE